

COUNTY OF LOS ANGELES
ROAD DEPARTMENT

PRECISE
BENCH MARK LIST



LA MIRADA QUAD

1965 ADJUSTMENT

ABBREVIATIONS USED IN BENCH MARK LISTINGS

ABUT - - - - -	Abutment	EC - - - - -	End of Curve
ALG - - - - -	Along	ENT - - - - -	Entrance
ANG PT - - - - -	Angle Point	FL - - - - -	Floor
B/W - - - - -	Back of Walk	FTG - - - - -	Footing
BCR - - - - -	Beginning of Curb Return	F/W - - - - -	Front of Walk
BC - - - - -	Beginning of Curve	GAR - - - - -	Garage
BLDG - - - - -	Building	HDWL - - - - -	Headwall
BM - - - - -	Bench Mark	HSE - - - - -	House
BT SPK - - - - -	Boat or Bolt Spike	INT - - - - -	Intersection
BR CAP - - - - -	Brass or Bronze Cap	IP - - - - -	Iron Pipe
C B - - - - -	Catch Basin	LT - - - - -	Left
CTR - - - - -	Center	LACE - - - - -	L. A. City Engineer
● L - - - - -	Center Line	LACS - - - - -	L. A. County Engineer
C/L INT - - - - -	Center Line Intersection	LAFC - - - - -	L. A. Co. Flood Control
C/L PROD - - - - -	Center Line Produced	L+BN - - - - -	Lead and Bench Nail
CONC - - - - -	Concrete	L+BR - - - - -	Lead and Brad
COR - - - - -	Corner	L+N - - - - -	Lead and Nail
COE - - - - -	Corps of Engineers	L+RDEM TAG - - - - -	Lead and Road Dept. Bench Mark Tag
CULV - - - - -	Culvert	L+SPK - - - - -	Lead and Spike
CB - - - - -	Curb	L+T - - - - -	Lead and Tack
CS MON - - - - -	County Engineer Monument	MCR - - - - -	Middle of Curb Return
CS BR CAP - - - - -	County Engineer Brass Cap	MKD - - - - -	Marked
CT SPK - - - - -	Cut Spike	MC - - - - -	Middle of Curve
DR - - - - -	Drive or Driveway	MON - - - - -	Monument
● /O - - - - -	East of	N/O - - - - -	North of
ECR - - - - -	End of Curb Return	NR - - - - -	Near

ABBREVIATIONS USED IN BENCH MARK LISTINGS . . . CONTINUED

OPP - - - - - Opposite
PI - - - - - Point of Intersection
PK+W - - - - - PK Nail and Washer
P/L - - - - - Property Line
POST - - - - - Point on Semi-Tangent
PP - - - - - Power Pole
PVMF - - - - - Pavement
PROD - - - - - Produced
RD - - - - - Road
RDEM - - - - - Road Dept. Bench Mark
RR - - - - - Railroad
RT - - - - - Right
R/W - - - - - Right of Way
SDMH - - - - - Storm Drain Manhole
SMH - - - - - Sewer Manhole
SPK - - - - - Spike
ST+W - - - - - Spike Tin and Washer
S/O - - - - - South of
TP - - - - - Telephone Pole
USC+GS - - - - - U. S. Coast and Geodetic Survey
USGS - - - - - U. S. Geological Survey
WK - - - - - Walk
W/O - - - - - West of

QUAD

SANTA FE

QUAD

NORWALK

ARTESIA QUAD

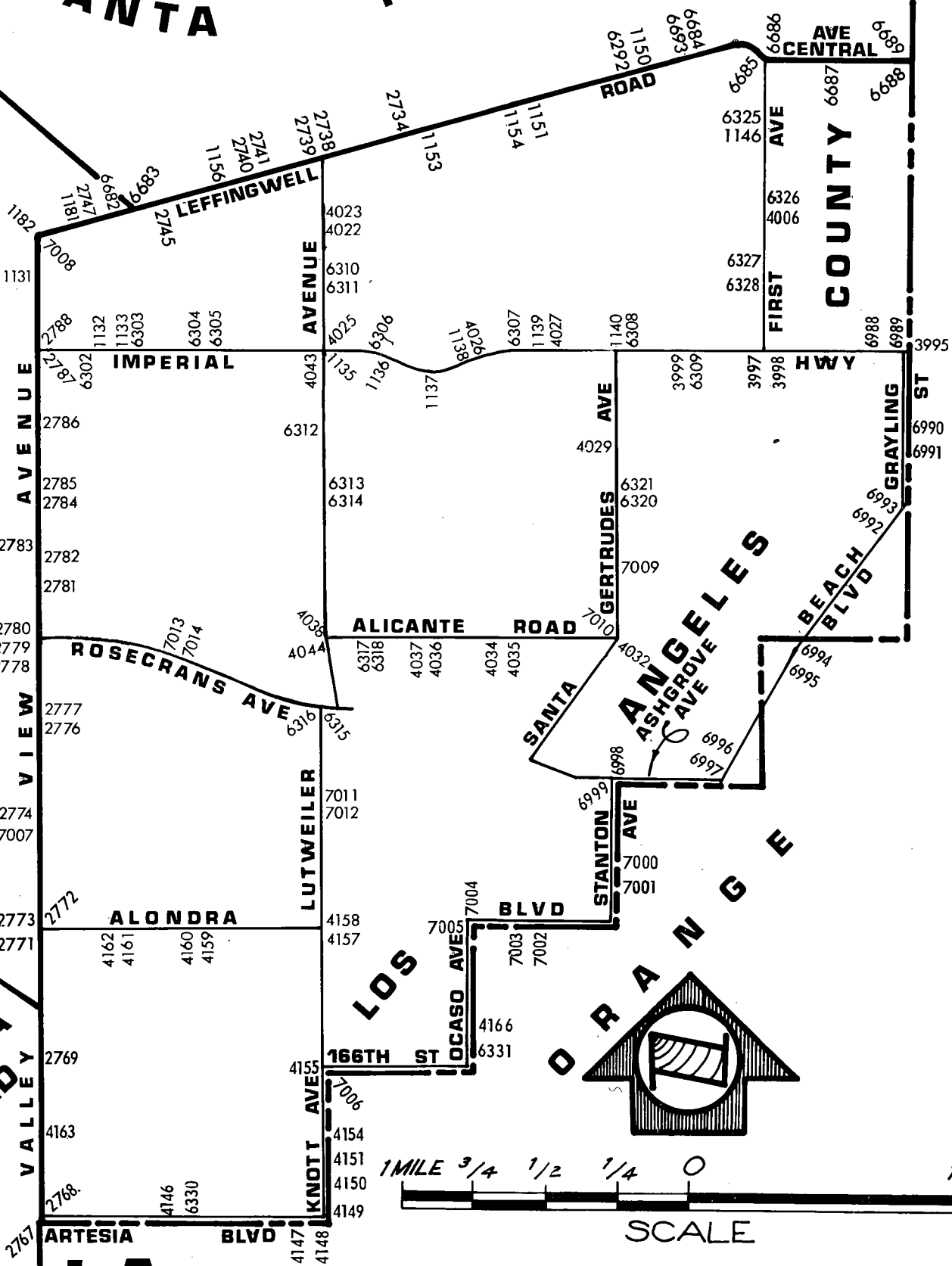

COUNTY

COUNTY

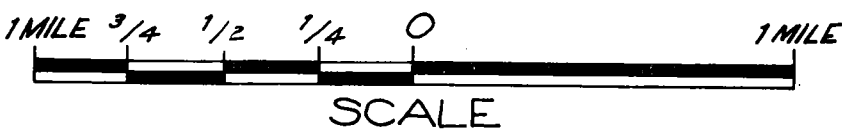
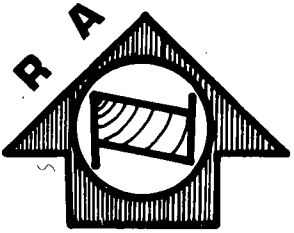

LA MIRADA QUAD

QUAD-YEAR	ELEV	DESCRIPTION (INCLUDE QUAD AND YEAR IN DESCRIPTION)	BM NUMBER
BASELINE (1965)	144.246	CS TRI MON IN WELL 8IN DN 0.2MI± N IMPERIAL HWY + 11FT± W C/L VALLEY VIEW AVE NR CREST OF HILL MKD (WHITTIER I-10A)	BY 1131
LAMIRADA (1965)	134.139	RDBM TAG N CB 3FT E BCR @ NW COR IMPERIAL HWY + CORLEY DR 40FT N + 43FT W C/L INT	BY 1132
LAMIRADA (1965)	160.049	CS TRI MON IN WELL 8IN DN @ OR NR C/L INT IMPERIAL HWY + BURCELLA AVE 3FT N + 3FT W C/L INT MKD (J 10B)	BY 1133
LAMIRADA (1965)	191.463	CS TRI MON IN WELL 8IN DN @ OR NEAR C/L INT IMPERIAL HWY + LUITWIELER AVE MKD (K-10 WHITTIER RESET 1960)	BY 1135
LAMIRADA (1965)	171.731	L+T CTR CONC HDWL 27FT S C/L IMPERIAL HWY 250FT E C/L LAS FLORES AVE	BY 1136
LAMIRADA (1965)	209.401	CS MON IN WELL 90FT S ENT HSE NO 1521 CORDOVA RD 50FT S C/L IMPERIAL HWY + 43FT W CORDOVA RD	BY 1137
LAMIRADA (1965)	227.025	CS MON 3FT S BCR @ SW COR IMPERIAL HWY + OCASO AVE	BY 1138
LAMIRADA (1965)	249.619	CS TRI MON IN WELL 10IN DN ON C/L IMPERIAL HWY 100FT S SANTA GERTRUDES AVE NR CREST OF SMALL HILL (RM NO LA HABRA A-10 1960)	BY 1139
LAMIRADA (1965)	256.745	CS MON IN WELL 12IN DN @ OR NR C/L INT IMPERIAL HWY + SANTA GERTRUDES AVE MKD (AUX LA HABRA A 10 A)	BY 1140
LAMIRADA (1965)	256.411	RDBM TAG 1FT S BCR @ SW COR FIRST AVE + SHARONHILL DR 3/FT W + 60FT S C/L INT	BY 1146
BASELINE (1965)	241.352	L+BN IN CB 36FT E BCR @ NE COR LEFFINGWELL RD + SANTA GERTRUDES AVE 40FT N + 145FT E C/L INT 1FT E ENT CATCH BASIN	BY 1150
BASELINE (1965)	234.542	L+BN IN CB 40FT S C/L LEFFINGWELL RD + 36 FT E C/L PROD EL ARCO DR OPP PP NO 1173876E	BY 1151
BASELINE (1965)	224.728	CS MON 13FT E + 3FT S C/L INT STAMY RD + LEFFINGWELL RD	BY 1153
BASELINE (1965)	228.565	CS MON IN WELL 12IN DN IN PKWY 14FT S C/L LEFFINGWELL RD + 619FT E C/L SCOTT AVE MKD (RM 2 LA HABRA A 9 1950)	BY 1154
BASELINE (1965)	212.495	CS MON IN WELL 13FT N C/L LEFFINGWELL RD 100FT W HSE NO 14701 + OPP PP NO 662000E MKD (WHITTIER J 9 AUX 1 1960)	BY 1156
BASELINE (1965)	161.724	L+T E EDGE CONC DRWY HSE NO 14312 37FT± S C/L LEFFINGWELL RD	BY 1181
BASELINE (1965)	158.482	CS REF MON IN WELL 13IN DN ON SE LY COR VALLEY VIEW AVE + LEFFINGWELL RD + 60FT± E C/L INT MKD (RM NO 41-10 1960)	BY 1182
BASELINE (1965)	224.828	L+BN 3FT W BCR @ NW COR LEFFINGWELL RD + STAMY RD 36FT N + 60FT W C/L INT	BY 2734
BASELINE (1965)	216.660	L+T DEP CB DRWY GAS STA NW COR LUITWIELER AVE + LEFFINGWELL RD 70FT W + 40FT N C/L INT	BY 2738
BASELINE (1965)	216.768	L+T 7FT E BCR @ SW COR LEFFINGWELL RD + LUITWIELER AVE 41FT S + 50FT W C/L INT	BY 2739

QUAD-YEAR	ELEV	DESCRIPTION (INCLUDE QUAD AND YEAR IN DESCRIPTION)	BM NUMBER
BASELINE (1965)	191.540	L+BN W END CATCH BASIN N SIDE LEFFINGWELL RD 40FT N C/L + 450FT W C/L LUITWIELER AVE 500FT E C/L ARROYO DR	BY 2740
BASELINE (1965)	186.363	L+BN 1FT W BCR @ SW COR LEFFINGWELL RD + ARROYO DR 40FT S + 50FT W C/L INT	BY 2741
BASELINE (1965)	188.178	CS MON 11FT# N C/L LEFFINGWELL RD 44FT# W OF C/L INT TELEGRAPH RD + LEFFINGWELL RD 30FT# S C/L TELEGRAPH RD	BY 2745
BASELINE (1965)	55.142	L+T E EDGE CONC WK TO 14158 53FT# S C/L ARTESIA AVE 100# W VALLEY VIEW AVE 30FT# FROM END WK	BY 2767
BASELINE (1965)	53.706	CS MON C/L INT VALLEY VIEW AVE + ARTESIA AVE OLD STYLE MON	BY 2768
BASELINE (1965)	60.246	USGS MON NW COR SPRR CONC CULV BRIDGE 26FT# E C/L VALLEY VIEW AVE 5FT# N OF RAIL 500FT# S FIRESTONE BLVD	BY 2769
BASELINE (1965)	65.453	L+BN W CB 7FT# N OF BCR @ SW COR ALONDRA BLVD + VALLEY VIEW AVE 68FT# S + 40FT# W C/L INT	BY 2771
BASELINE (1965)	66.038	LACS MON IN WELL COVER 100FT# + 12FT# N C/L INT ALONDRA BLVD + VALLEY VIEW AVE	BY 2772
BASELINE (1965)	66.824	L+T C/L INT VALLEY VIEW AVE + ALONDRA BLVD INT OF 4 L+TS	BY 2773
BASELINE (1965)	69.167	L+BN CONC BASE OF S 6IN IP GATE POST 10FT# W + 15FT# N OF PP NO 4491 (E 16TH POLE NO OF ALONDRA BLVD) 30FT# W VALLEY VIEW AVE	BY 2774
BASELINE (1965)	94.746	L+SPK N CB 4FT# E BCR @ NE COR VALLEY VIEW AVE + STAGE RD 30FT# N + 60FT# E C/L INT CB MKD (RBM 1)	BY 2776
BASELINE (1965)	94.776	USC+GS MON FLUSH ON NE COR VALLEY VIEW AVE + STAGE RD 31.5FT# N + 87FT# E C/L INT 1.5FT# N CB MKD (K 778-1945)	BY 2777
BASELINE (1965)	110.290	CS MON IN WELL 11IN DN ON 11FT# W C/L VALLEY VIEW AVE + 100FT# S ROSECRANS AVE MKD (RE 329)	BY 2778
BASELINE (1965)	111.571	CS TRI MON IN WELL 14IN DN ON SW COR VALLEY VIEW AVE + ROSECRANS AVE 12FT# S + 11FT# W C/L INT MKD (WHITTIER I 12 1952)	BY 2779
BASELINE (1965)	112.629	L+T @ C/L INT VALLEY VIEW AVE + ROSECRANS AVE	BY 2780
BASELINE (1965)	118.184	L+T C/L VALLEY VIEW AVE @ CREST OF GRADE 540FT# N ROSECRANS AVE 55FT# N OF N EDGE OF HSE NO 14021 VALLEY VIEW AVE 4FT# S OF AN EXPANSION JOINT IN CONC PVMT	BY 2781
BASELINE (1965)	94.285	L+BN NR CTR OF BRIDGE NO 1273 40FT# E C/L VALLEY VIEW AVE + 800FT# S FOSTER RD	BY 2782
BASELINE (1965)	93.559	L+T IN CHIS SQ 5FT# E C/L VALLEY VIEW AVE + 75FT# N BRIDGE NO B1273 725FT# S FOSTER RD	BY 2783
BASELINE (1965)	95.553	L+T ON C/L VALLEY VIEW AVE @ FOSTER RD (SLY L+T OF 2 L+TS 12FT APART)	BY 2784
BASELINE (1965)	94.733	CS MON IN WELL 10IN DN ON NE COR VALLEY VIEW AVE + FOSTER RD 62FT# N + 41FT# E C/L INT 1FT# BACK CB MKD (BM 1=6A 1961)	BY 2785

QUAD-YEAR	ELEV	DESCRIPTION (INCLUDE QUAD AND YEAR IN DESCRIPTION)	BM NUMBER
BASELINE (1965)	106.006	L+BN E CB 1FT± N BCR @ NE COR VALLEY VIEW AVE + ADOREE ST 57FT± N + 38FT± E C/L INT	BY 2786
BASELINE (1965)	114.414	CS MON IN WELL 15IN DN ON SE COR VALLEY VIEW AVE + IMPERIAL HWY 12FT± S + 12FT± E C/L INT MKD (BM 1-7 1951) OUT	BY 2787
BASELINE (1965)	115.916	L+BN E CB 1FT± S BCR @ SE COR VALLEY VIEW AVE + IMPERIAL HWY 76FT± S + 38FT± E C/L INT	BY 2788
LAMIRADA (1965)	285.947	CS BM MON IN WELL FLUSH WITH CB TOP 40FT N C/L IMPERIAL HWY NEAR ORANGE CO LINE MKD (BM 3-13A 1961)	BY 3995
LAMIRADA (1965)	300.509	RD BM TAG S CB 1FT E BCR @ SE COR IMPERIAL HWY + FIRST AVE 40FT S + 56FT E C/L INT	BY 3997
LAMIRADA (1965)	299.880	CS TRI MON IN WELL 10IN DN @ OR NEAR C/L INT IMPERIAL HWY + FIRST AVE MKD (LA HABRA B-10-A)	BY 3998
LAMIRADA (1965)	268.103	L+T CONC CB 40FT S C/L IMPERIAL HWY + 347 FT W C/L BREEZEWOOD DR + IMPERIAL HWY (FRONT) OF PPNO1254813E)	BY 3999
LAMIRADA (1965)	255.762	RD BM TAG E CB 1FT S BCR @ SE COR FIRST AVE + AMBER VALLEY DR 56FT S + 30 E C/L INT	BY 4006
LAMIRADA (1965)	212.212	L+BN W EDGE WK MAIN ENT CHURCH BLDG 55FT N C/L GRANADA AVE 17FT E C/L INT GRANADA AVE + LUITWIELER AVE OUT	BY 4022
LAMIRADA (1965)	207.572	RD BM TAG 40FT E C/L LUITWIELER AVE 60FT N C/L GRANADA AVE	BY 4023
LAMIRADA (1965)	191.663	CS TIE MON IN WELL 8 IN DN ON NE COR IMPERIAL HWY + LUITWIELER AVE 58FT S + 5FT E C/L INT MKD (REF MON NO3 TO K-10) OUT	BY 4025
LAMIRADA (1965)	226.899	L+B S EDGE WK @ NW COR BRICK RET WALL HSE NO 15306 IMPERIAL HWY 60FT S C/L IMPERIAL HWY	BY 4026
LAMIRADA (1965)	253.172	L+BN E END 1ST STEP HSE NO15663 IMPERIAL HWY 55FT N C/L IMPERIAL HWY 764FT W SANTA GERTRUDES AVE OUT	BY 4027
LAMIRADA (1965)	268.604	L+BN N END CONC APRON TO GARAGE OF HSE NO13117 SANTA GERTRUDES AVE 211FT S IMPERIAL HWY 80FT W C/L SANTA GERTRUDES AVE	BY 4029
LAMIRADA (1965)	223.164	L+BRAD S CB 11FT E BCR @ SE COR ALICANTE RD + SANTA GERTRUDES AVE 30FT S + 95FT E C/L INT	BY 4032
LAMIRADA (1965)	216.479	L+BN 2FT N CB RET @ SW COR ALICANTE RD + MANCITA DR	BY 4034
LAMIRADA (1965)	212.236	L+BN 2FT N CB RET @ SE COR ALICANTE RD + LA MESA DR	BY 4035
LAMIRADA (1965)	180.531	L+BN 2FT N CB RET @ SE COR ALICANTE RD + ADELFA DR	BY 4036
LAMIRADA (1965)	179.326	L+BN 2FT N CB RET @ SW COR ALICANTE RD + ADELFA DR	BY 4037
LAMIRADA (1965)	146.104	L+BN W CB LUITWIELER AVE 100FT S C/L WHITEROCK DR OPP PP NO 1063580-E	BY 4038
LAMIRADA (1965)	194.802	L+BN NW COR CONC WK @ SE COR HSE NO15002 IMPERIAL HWY 60FT E C/L IMPERIAL HWY + 55FT E C/L LUITWIELER AVE OUT	BY 4043

QUAD-YEAR	ELEV	DESCRIPTION (INCLUDE QUAD AND YEAR IN DESCRIPTION)	BM NUMBER
LAMIRADA (1965)	141.132	L+BN W CB LUITWIELER AVE 200FT S C/L ALICANTE PROD OPP PP NO1081377-E	BY 4044
LAMIRADA (1965)	63.830	SPK CONC @ NE COR BRIDGE NO53-298 12FT N C/L ARTESIA AVE	BY 4146
LAMIRADA (1965)	64.737	L+BN SE COR OF CONC ABUT @ E END SUSPENSION BRIDGE 40FT S SPRR + ARTESIA AVE	BY 4147
LAMIRADA (1965)	63.013	L+T S HDWL SANTA ANA FREEWAY @ STA 629+00	BY 4148
LAMIRADA (1965)	62.823	L+BN S HDWL SANTA ANA FREEWAY @ STA 629+00	BY 4149
LAMIRADA (1965)	62.339	L+T S HDWL SANTA ANA FREEWAY @ STA 634+75	BY 4150
LAMIRADA (1965)	64.137	L+B N CB SERVICE @ SANTA ANA FREEWAY @ STA 638+00(BC)	BY 4151
LAMIRADA (1965)	64.286	2 IN IP @ NE COR @ LINE RADIO STA KFI + 60FT W HSE NO162 @ KNOTT AVE	BY 4154
LAMIRADA (1965)	85.696	L+T @ SW COR CONC DR @ NO16300 KNOTT AVE 30FT E C/L KNOTT AVE	BY 4155
LAMIRADA (1965)	109.903	CS BM MON IN WELL 10IN DN +33FT SW C/L STAGE RD + 150FT SE ALONDRA BLVD	BY 4157
LAMIRADA (1965)	109.851	CS MON @ APPROX C/L INT ALONDRA ST + ESCALONA RD 16IN DN 72FT N C/L STAGE RD MKD (22-23-27-26)	BY 4158
LAMIRADA (1965)	85.970	L+BN W CB @ COR TO BLDG NO14758 ALONDRA BLVD 30FT @ ALONDRA BLVD	BY 4159
LAMIRADA (1965)	81.876	L+BN SE COR @ INLET 100FT W HSE NO14734 ALONDRA BLVD @ 2 FT S C/L ALONDRA BLVD	BY 4160
LAMIRADA (1965)	71.346	L+BN E END N HDWL BRIDGE 45FT SE PP NO111- 3665E +0.3MI @ VALLEY VIEW ST 16FT N C/L ALONDRA BLVD	BY 4161
LAMIRADA (1965)	68.853	L+BN E END OF S HDWL OF BRIDGE 50FT SW PP NO1300920 @ 16FT S ALONDRA BLVD 0.2MI E VALLEY VIEW AVE	BY 4162
BASELINE (1965)	57.944	L+BN N END WK TO CROWN FERTILIZER CO 55FT± W C/L VALLEY VIEW AVE	BY 4163
LAMIRADA (1965)	98.642	CS CON SYSTEM STD DISC IN WELL W/COVER 0.4MI NW ALONG THE AT +SFRR FROM THE BUENA PARK STATION @ THE LA CO LINE @ NE OF NE RAIL + 10FT SW C/L STAGE RD	BY 4166
BASELINE (1965)	240.274	RD MON IN WELL 8IN DN 30FT E + 7FT S C/L INT LEFFINGWELL RD + SANTA GERTRUDES AVE MKD (LA CO RD DEPT 1960)	BY 6292
LAMIRADA (1965)	135.785	L+T S CB IMPERIAL HWY 40FT S C/L ON OR NEAR C/L PROD CORLEY DR	BY 6302
LAMIRADA (1965)	160.774	CE TAG SW COR CONC BASE OF GAS VENT IN IS- LAND ON NE COR IMPERIAL HWY + BURGESS AVE 50FT N + 40FT E C/L INT	BY 6303
LAMIRADA (1965)	137.413	RD BM TAG 1FT E CB ON S SIDE IMPERIAL HWY 40FT S C/L + 84FT E C/L PROD SPRING VIEW RD	BY 6304

QUAD-YEAR	ELEV	DESCRIPTION (INCLUDE QUAD AND YEAR IN DESCRIPTION)	BM NUMBER
LAMIRADA (1965)	137.246	RD BM TAG SE COR CB ON NE COR IMPERIAL HWY + SPRINGVIEW RD 40FT N + 110FT E C/L INT	BY 6305
LAMIRADA (1965)	176.213	RD MON IN WELL 8 IN DN ON C/L PROD IMPERIAL HWY + ON C/L ORES AVE 67FT E PI ON IMPERIAL HWY	BY 6306
LAMIRADA (1965)	224.205	RD BM TAG NE COR C/L 40FT N C/L IMPERIAL HWY 1000FT E OCASO AVE	BY 6307
LAMIRADA (1965)	257.494	L+BN CTR CB RET @ NE COR IMPERIAL HWY + SANTA GERTRUDES AVE 50FT N + 40FT E C/L INT	BY 6308
LAMIRADA (1965)	280.778	L+T S CB SERVICE ISLAND @ SW COR IMPERIAL HWY + BREEZEWOOD DR 58FT S + 35FT W C/L INT	BY 6309
LAMIRADA (1965)	194.343	L+BN E CB LUITWILER AVE 40FT E C/L + 600FT S C/L GRANADA AVE NR INT OF 5FT CONC BLOCK WALLS	BY 6310
LAMIRADA (1965)	191.575	RD BM TAG 1FT S CB C/L LUITWIELER AVE 800FT S GRANADA AVE	BY 6311
LAMIRADA (1965)	176.545	L+BN E CB OF SERVICE RD @ SW COR LUITWIELER AVE + TACUBA DR 45FT S + 80FT W C/L INT	BY 6312
LAMIRADA (1965)	155.019	L+BN E CB 1.0FT N BCR @ NE COR LUITWIELER AVE + FOSTER RD 66FT N + 40FT E C/L INT PAINTED BM NO2	BY 6313
LAMIRADA (1965)	155.538	CO ENG TAG + L 5FT E BCR @ SE COR LUITWIELER AVE + FOSTER RD 32FT S + 78FT E C/L INT	BY 6314
LAMIRADA (1965)	130.804	L+BRAD S CB 15FT E BCR @ SE COR ROSECRANS AVE + LUITWIELER AVE 40FT S + 90FT E C/L INT @ E END CB	BY 6315
LAMIRADA (1965)	128.939	RD DEPT BM TAG W CB 12FT S BCR @ SW COR ROSE- CRANS AVE + LUITWIELER AVE 40FT W + 87FT S C/L INT	BY 6316
LAMIRADA (1965)	138.881	RD BM TAG S CB 1.5FT W BCR @ SW COR ALICANTE RD + BLUE FIELD AVE 20FT S + 46FT W C/L INT	BY 6317
LAMIRADA (1965)	140.160	L+PK S CB 1.2FT E BCR @ SE COR ALICANTE RD + BLUEFIELD AVE 20FT S + 46FT E C/L INT	BY 6318
LAMIRADA (1965)	263.140	L+BRAD E CB SERVICE RD 5FT N BCR @ SE COR SANTA GERTRUDES AVE + FOSTER RD 33FT S + 14FT E SERVICE RD INT	BY 6320
LAMIRADA (1965)	263.318	L+T E CB SERVICE RD 5FT N BCR @ NE COR SANTA GERTRUDES AVE + FOSTER RD 45FT N + 18FT E C/L INT	BY 6321
LAMIRADA (1965)	257.494	RAMSET W CB SERVICE RD 0.3FT N BCR @ NW COR FIRST AVE + SHARON HILL DR 70FT W + 44FT N C/L INT	BY 6325
LAMIRADA (1965)	250.808	CS BM BRASS DISK IN SW COR CULVERT 33FT E C/L FIRST AVE + 263FT N AMBER VALLEY DR	BY 6326
LAMIRADA (1965)	273.423	RD BM TAG W CB 1FT N BCR @ NW COR FIRST AVE + CANDLELIGHT DR 58FT N + 32FT W C/L INT	BY 6327
LAMIRADA (1965)	276.683	RD BM TAG E CB 1FT S BCR @ SE COR FIRST AVE + CANDLELIGHT DR 56FT S + 32FT E C/L INT	BY 6328
LAMIRADA (1965)	58.975	FLOOD CONT MON 16 IN SW COR 5FT CHAIN LINK FEN 10FT W BRIDGE 53-01 N C/L ARTESIA BLVD MKD (109 RW 113)	BY 6330

QUAD-YEAR	ELEV	DESCRIPTION (INCLUDE QUAD AND YEAR IN DESCRIPTION)	BM NUMBER
LAMIRADA (1965)	99.066	RD BM TAG N CB STATION 30FT NLY C/L NEAR WLY END 6FT CHAIN LINE ALSO NR LA CO LINE	BY 6331
BASELINE (1965)	188.441	RDBM TAG 5FT W BCR @ SE COR 53FT E + 43FT S C/L INT TELEGRAPH RD + COLIMA RD	BY 6682
BASELINE (1965)	187.395	CS MON @ C/L INT LEFFINGWELL RD + TELEGRAPH RD MKD (WHITTIER ROAD BOX 1 RE 5869 1960)	BY 6683
BASELINE (1965)	253.811	L+BN S CB 2FT E C B 437FT E C/L MILVERN DR + 40FT S C/L LEFFINGWELL RD	BY 6684
BASELINE (1965)	265.717	RDBM TAG SW CB 48FT W + 28FT S C/L INT LEFFING- WELL RD + FIRST AVE 2FT E BCR	BY 6685
BASELINE (1965)	267.131	RDBM TAG N CB 113FT E + 38FT N C/L INT LEFFING- WELL RD + FIRST AVE 2FT E FIRST C B	BY 6686
BASELINE (1965)	279.207	L+T S CB LEFFINGWELL RD 40FT S + 55FT E C/L INT TIGRINA AVE + LEFFINGWELL RD	BY 6687
BASELINE (1965)	293.716	BN @ NW COR 2FT E BCR 48FT W + 34FT N C/L INT VALLEY HOME AVE + LEFFINGWELL RD	BY 6688
BASELINE (1965)	295.404	SPK @ NE COR 3FT S BCR 54FT N + 18FT E C/L INT VALLEY HOME AVE + LEFFINGWELL RD	BY 6689
BASELINE (1965)	253.084	RDBM TAG N CB 2FT E C B 391FT E C/L MILVERN DR + 40FT N C/L LEFFINGWELL RD	BY 6693
LAMIRADA (1965)	259.725	L + BN S CB IMPERIAL HWY 1FT W/O C B 40FT S + 564FT E C/L INT IMPERIAL HWY + TIGRINA AVE	BY 6988
LAMIRADA (1965)	284.025	L+T N CB IMPERIAL HWY 40FT N + 1320FT E C/L INT IMPERIAL HWY + TIGRINA AVE 10FT E PP NO 1214437 E + 50FT E LA + ORANGE CO LINE	BY 6989
LAMIRADA (1965)	258.212	LS TAG 2600 E CB 2FT S BCR @ NE COR GRAYLING AVE + BRASS LANTERN DR 41FT N + 18FT E C/L INT	BY 6990
LAMIRADA (1965)	259.902	LS TAG 2600 S CB BRASS LANTERN DR 15FT S C/L + @ C/L PROD GRAYLING AVE	BY 6991
LAMIRADA (1965)	196.669	L+BN NLY END HDWL NO A123+34 LOC 50FT ELY C/L BEACH BLVD + 300FR SLY COUNTY LINE MKD (BM)	BY 6992
LAMIRADA (1965)	197.545	L+BN NLY END HDWL NO E118+87 LOC 50FT ELY C/L BEACH BLVD + 300FR SLY COUNTY LINE MKD (BM)	BY 6993
LAMIRADA (1965)	197.914	ORANGE C S BR DISK IN NELY COR 2X1.5FT CONC PAD OF STORM DRAIN AIR VENT 1MI SWLY INT IMPERIAL HWY + 60FT WLY C/L BEACH BLVD MKD (CSBM RE 7872 OR CO)	BY 6994
LAMIRADA (1965)	194.410	L+BN CTR HDWL NO D89+23 LOC 58FT WLY C/L BEACH BLVD + 0.5MI NLY ROSECRANS BLVD MKD (BM)	BY 6995
LAMIRADA (1965)	149.094	CS MON IN NE END BR B 1220 ONNWLY COR BEACH BLVD + ROSECRANS AVE 88FT NW + 44FT NE C/L INT	BY 6996
LAMIRADA (1965)	147.859	L+T SW COR BR B 1220 ON SW COR ROSECRANS BLVD + BEACH BLVD 40FT S + 160FT W C/L INT	BY 6997
LAMIRADA (1965)	133.382	L+BN N CB 1FT E BCR @ NE COR ASHGROVE DR + STAN- TON AVE 60FT N + 50FT E C/L INT MKD (BM)	BY 6998
LAMIRADA (1965)	132.687	L+BN W CB 1FT N BCR @ SW COR ASHGROVE DR + STANTON AVE 44FT S + 20FT W C/L INT MKD (BM)	BY 6999

QUAD-YEAR	ELEV	DESCRIPTION (INCLUDE QUAD AND YEAR IN DESCRIPTION)	BM NUMBER
LAMIRADA (1965)	114.014	L+BN WLY CB STANTON AVE 18FT WLY + 270FT SLY C/L CARREY AVE MKD (BM)	BY 7000
LAMIRADA (1965)	108.250	L+BN NLY CB 1FT WLY BCR @ NWLY COR CALVERTON DR + 1 BLOCK NLY OF HAYFORD ST 47FT WLY + 25FT NLY C/L INT MKD (BM)	BY 7001
LAMIRADA (1965)	115.601	CS TAG NELY CB 40FT NLY BCR @ NELY COR ALONDRA BLVD + LUITWEILER AVE 100FT NWLY + 36FT NELY C/L INT	BY 7002
LAMIRADA (1965)	117.612	CS TAG NLY CB 2FT WLY BCR @ NWLY COR ALONDRA BLVD + LUITWEILER AVE 40FT NLY + 122FT WLY C/L INT	BY 7003
LAMIRADA (1965)	114.919	L+T N CB ALONDRA BLVD 40FT NLY + 30FT WLY C/L PROD OCASO AVE	BY 7004
LAMIRADA (1965)	115.018	L+T S CB 2FT W BCR @ SW COR ALONDRA BLVD + OCASO AVE 40FT S + 55FT W C/L INT	BY 7005
LAMIRADA (1965)	92.612	ORANGE CO BR 100 FT SW COR DRWY TO HSE 16200 KNOTT AVE 30FT E C/L	BY 7006
BASELINE (1965)	68.305	USC+GS MON FL 846FT N ALONDRA BLVD + 27FT W C/L VALLEY VIEW AVE MKD (J 778 1945)	BY 7007
BASELINE (1965)	162.513	L+BRAD ELY CB 12FT S BCR @ NELY COR VALLEY VIEW AVE + LEFFINGWELL RD 88FT N + 42FT E C/L INT	BY 7008
LAMIRADA (1965)	225.436	L+T W CB 30FT N FENCE COR OF GOLF COURSE + 32FT W C/L SANTA GERTRUDES AVE 1500FT S FOSTER RD	BY 7009
LAMIRADA (1965)	228.727	L+BR N CB ALICANTE RD 40FT W BCR @ NW COR ALICANTE RD + SANTA GERTRUDES AVE 87FT W + 20FT N C/L INT	BY 7010
LAMIRADA (1965)	117.549	L+BN 5FT N BCR @ NE COR EXCELSIOR DR + ESCALONA RD 48FT N + 18FT E C/L INT	BY 7011
LAMIRADA (1965)	119.614	L+BN 1FT S BCR @ SE COR EXCELSIOR RD + ESCALONA RD 46FT S + 18FT E C/L INT	BY 7012
LAMIRADA (1965)	109.643	L+BM TAG S CB ROSECRANS AVE @ SW COR BIOLA AVE 2FT W BCR 86FT W + 38FT S C/L INT	BY 7013
LAMIRADA (1965)	109.011	L+BM TAG N CB ROSECRANS AVE @ NE COR BIOLA AVE 2FT E BCR 66FT E + 40FT N C/L INT	BY 7014